

**QAI Design B1067-1e –ROCKWOOL COMFORTBATT® / COMFORTBOARD™ 80
 CAN/ULC-S124 – Classification A & B protective covering for foamed insulation**

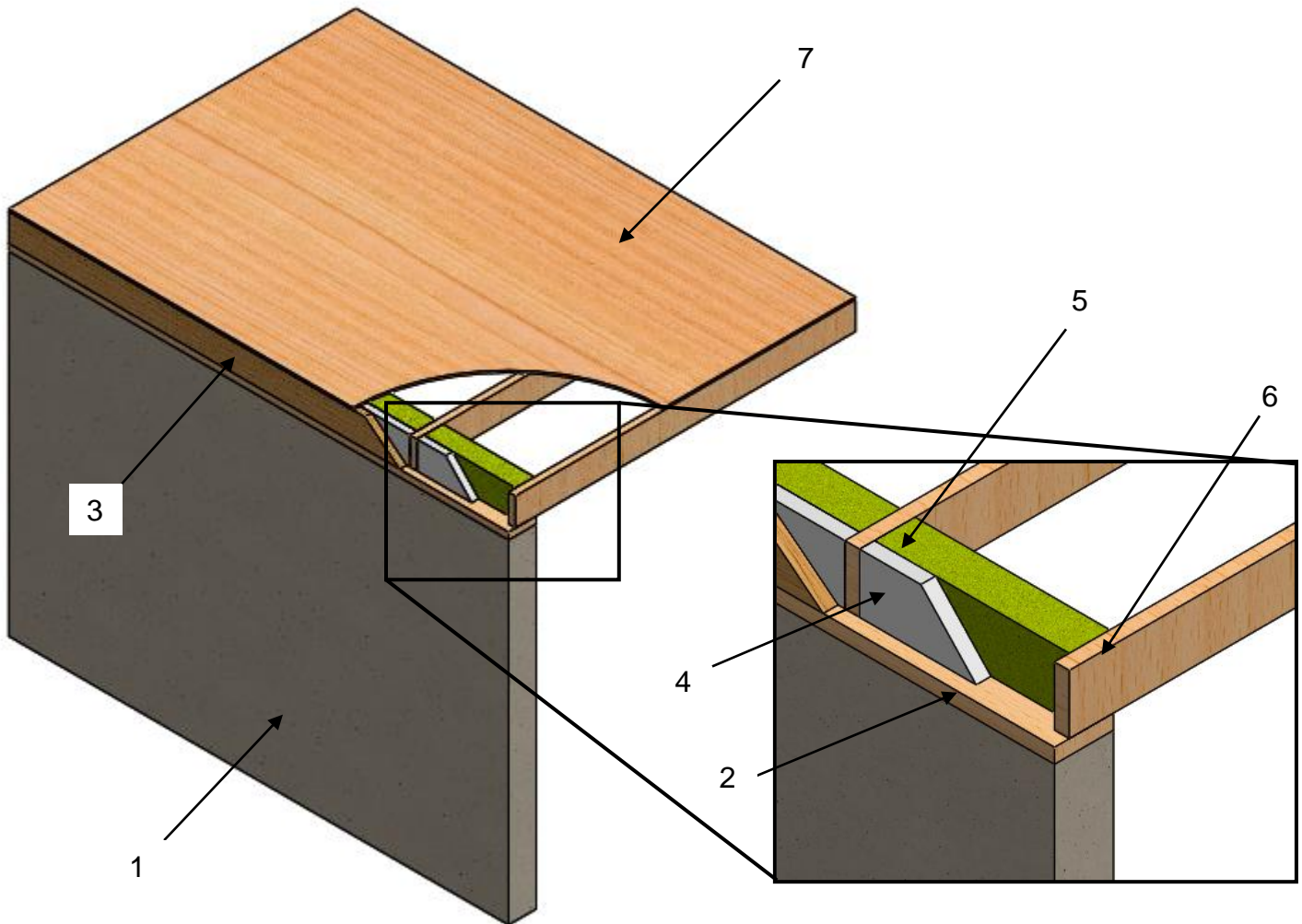

No.	COMPONENT	DESCRIPTION		
1	Concrete Foundation	Concrete foundation wall		
2	Bearing Plate	Standard bearing plate		
3	Rim Joist	Standard rim joist		
4	Foam Insulation	Type: Foamed Plastic		
		Maximum R-Value: 7.5 per inch		
5	Protective Covering of Foam Insulation	Certified Manufacturer: ROCKWOOL.		
		Certified Product Name: COMFORTBATT®	COMFORTBOARD™ 80	COMFORTBOARD™ 80
		Assembly Class: Classification B	Classification B	Classification A
		Minimum Thickness: 5-1/2 inch (140 mm)	2 in (50 mm)	3 in (76 mm)
		Minimum Density: 2 lb/ft ³ (32 kg/m ³)	8.0 lb/ft ³ (128 kg/m ³)	8.0 lb/ft ³ (128 kg/m ³)
		Installation: Friction fit into the joist cavity.		
6	Floor Joists	Standard floor joists system		
7	Sheathing	Standard floor sheathing		

**QAI Design B1067-1e –ROCKWOOL COMFORTBATT®/COMFORTBOARD™ 80
 CAN/ULC-S124 – Alternative Installation Method – Friction Fit Batt Insulation**

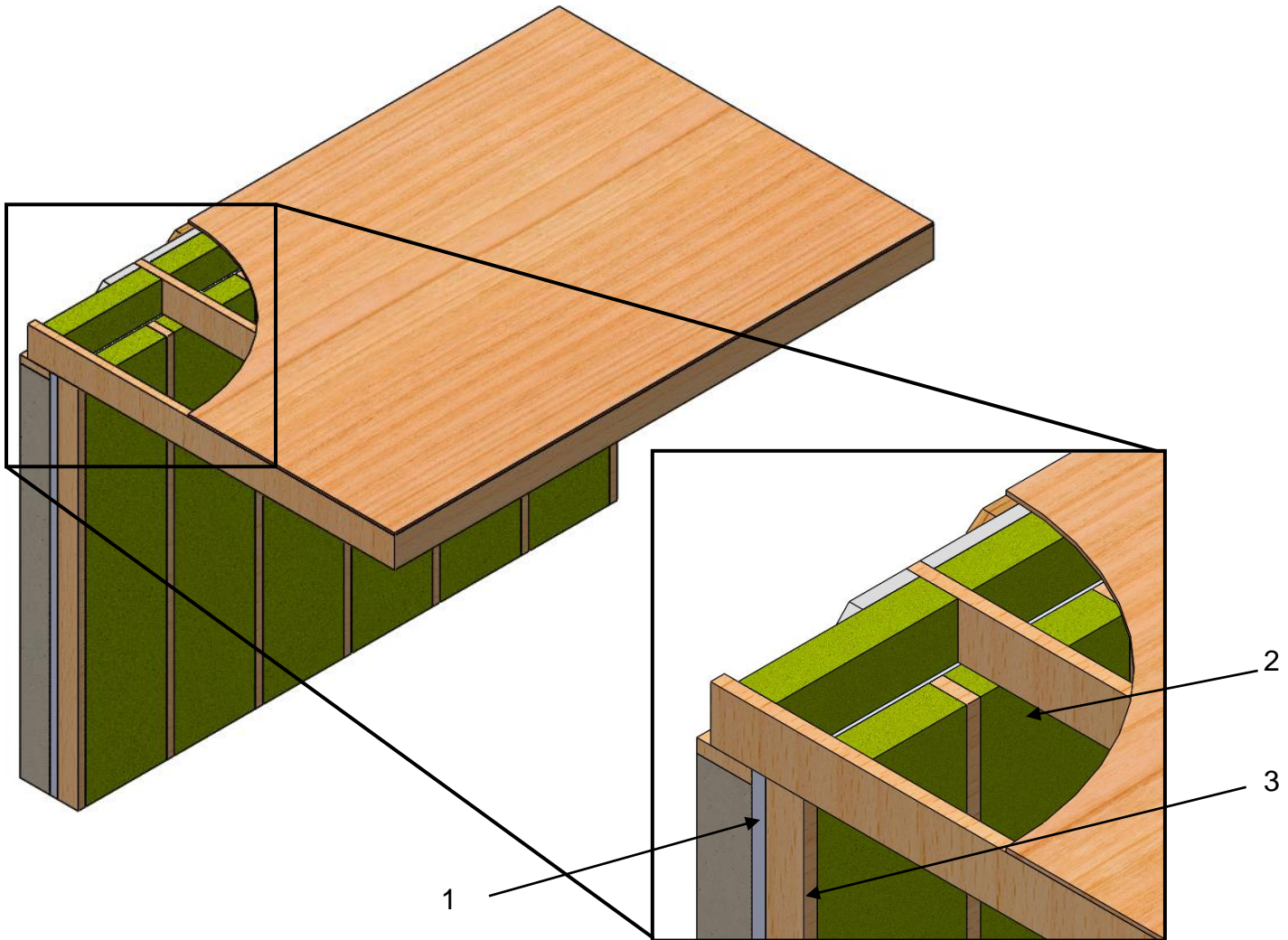

No.	COMPONENT	DESCRIPTION	
1	Foam Insulation	Type:	Foamed Plastic
		Maximum R-Value:	7.5/inch
2	Protective Covering of Foam Insulation	Certified Manufacturer:	ROCKWOOL
		Certified Product Name:	COMFORTBATT®
		Assembly Class:	Classification B
		Minimum Thickness:	5-1/2 inch (140 mm)
		Minimum Density:	2 lb/ft ³ (32 kg/m ³)
		Installation:	Friction fit into wall stud cavity.
3	Wall Studs	Minimum 2 inch x 6 inch (51 mm x 102 mm) wood wall studs	

**QAI Design B1067-1e –ROCKWOOL COMFORTBATT®/COMFORTBOARD™ 80
 CAN/ULC-S124 – Alternative Installation Method – Anchored Insulation Board**

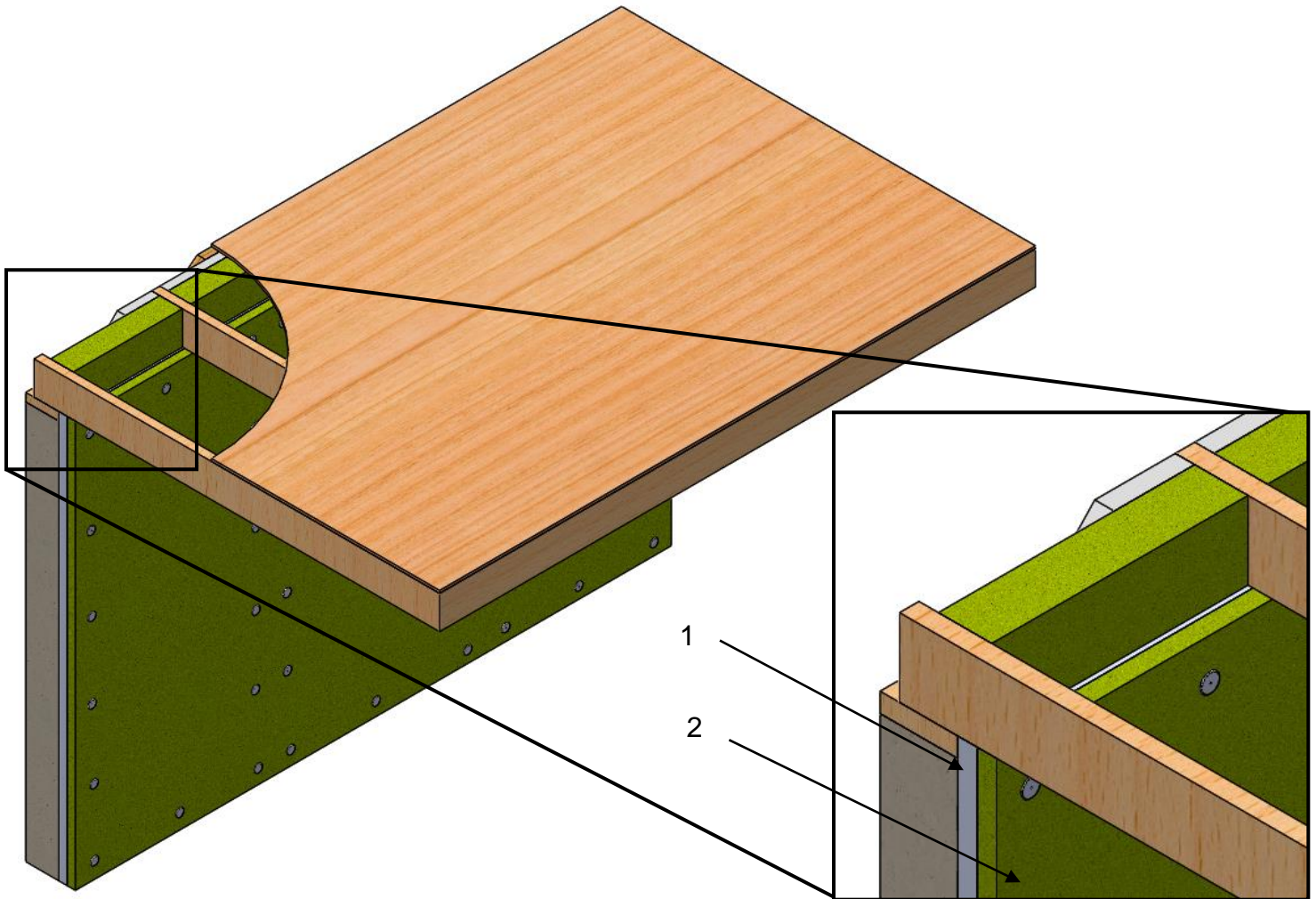

No.	COMPONENT	DESCRIPTION		
1	Foam Insulation	Type:	Foamed Plastic	
		Maximum R-Value:	7.5/inch	
2	Protective Covering of Foam Insulation	Certified Manufacturer:	ROCKWOOL	
		Certified Product Name:	ROCKWOOL COMFORTBOARD™ 80	
		Assembly Class:	Classification A	Classification B
		Minimum Thickness:	3 in (76 mm)	2 in (50 mm)
		Minimum Density:	8.0 lb/ft ³ (128 kg/m ³)	8.0 lb/ft ³ (128 kg/m ³)
		Installation:	Fastened through the foamed plastic using Ramset Insulfast insulation fasteners or non-combustible fasteners at manufacturer's recommended instructions, anchored into code compliant substrate. Tight butt-edge fit installation.	