

**QAI Design B1067-1e –ROCKWOOL COMFORTBATT® / COMFORTBOARD™ 80 / COMFORTBOARD™ 110 - CAN/ULC-S124 – Classification A & B protective covering for foamed insulation**

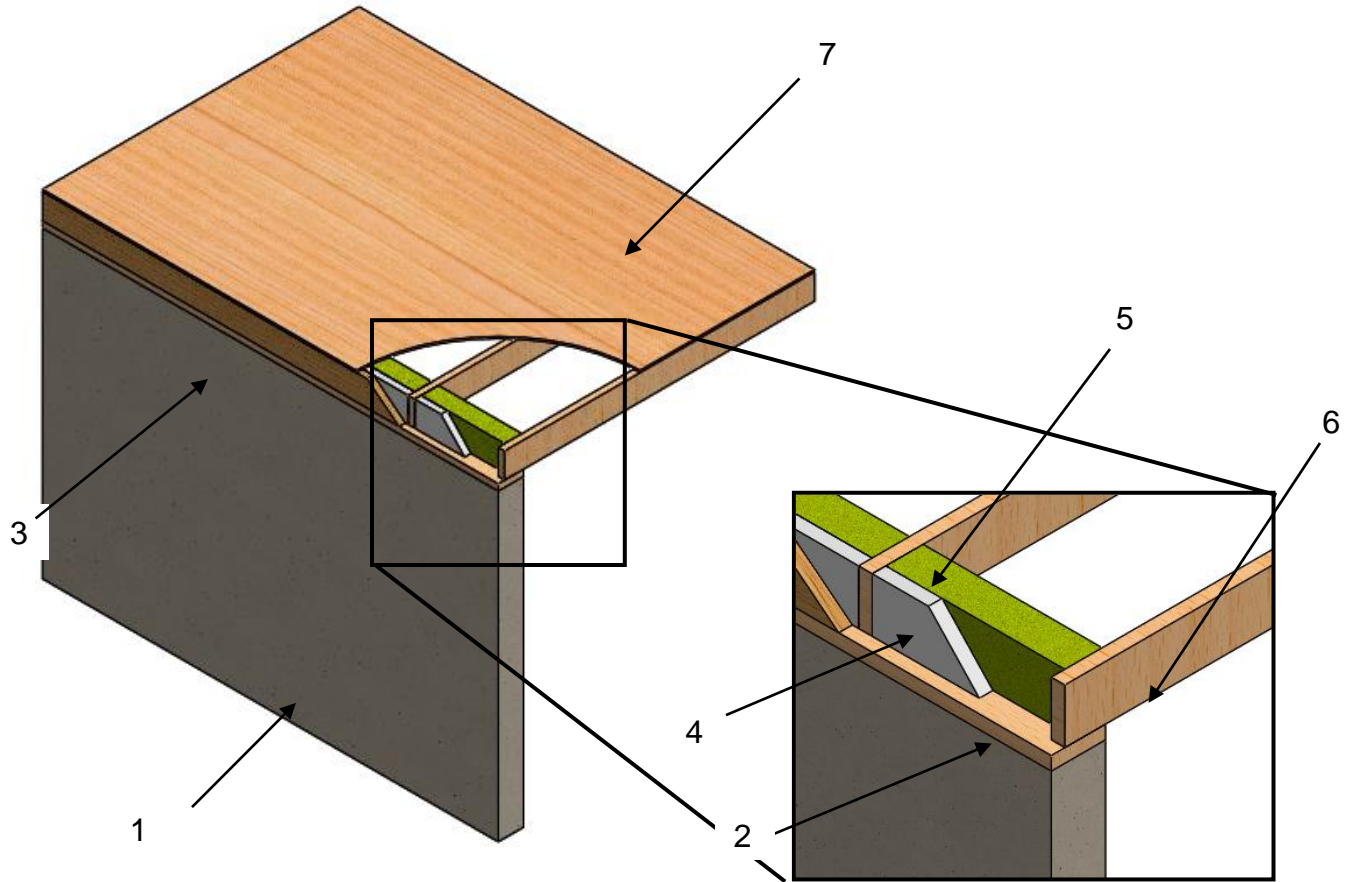

No	COMPONENT	DESCRIPTION					
1	Concrete Foundation	Concrete foundation wall					
2	Bearing Plate	Standard bearing plate					
3	Rim Joist	Standard rim joist					
4	Foam Insulation	Type:	Foamed Plastic				
		Maximum R-Value:	7.5 per inch				
5	Protective Covering of Foam Insulation	Certified Manufacturer:	ROCKWOOL.				
		Certified Product Name:	COMFORT BATT®	COMFORT BOARD™ 80	COMFORT BOARD™ 80	COMFORT BOARD™ 110	COMFORT BOARD™ 110
		Assembly Class:	<b>Classification B</b>	<b>Classification B</b>	<b>Classification A</b>	<b>Classification B</b>	<b>Classification A</b>
		Minimum Thickness:	5-1/2 inch (140 mm)	2 in (50 mm)	3 in (76 mm)	2 in (50 mm)	3 in (76 mm)
		Minimum Density:	2 lb/ft <sup>3</sup> (32 kg/m <sup>3</sup> )	8.0 lb/ft <sup>3</sup> (128 kg/m <sup>3</sup> )	8.0 lb/ft <sup>3</sup> (128 kg/m <sup>3</sup> )	11.0 lb/ft <sup>3</sup> (176 kg/m <sup>3</sup> )	11.0 lb/ft <sup>3</sup> (176 kg/m <sup>3</sup> )
		Installation:	Friction fit into the joist cavity.				
6	Floor Joists	Standard floor joists system					
7	Sheathing	Standard floor sheathing					

**QAI Design B1067-1e –ROCKWOOL COMFORTBATT® - CAN/ULC-S124 – Alternative Installation Method – Friction Fit Batt Insulation**

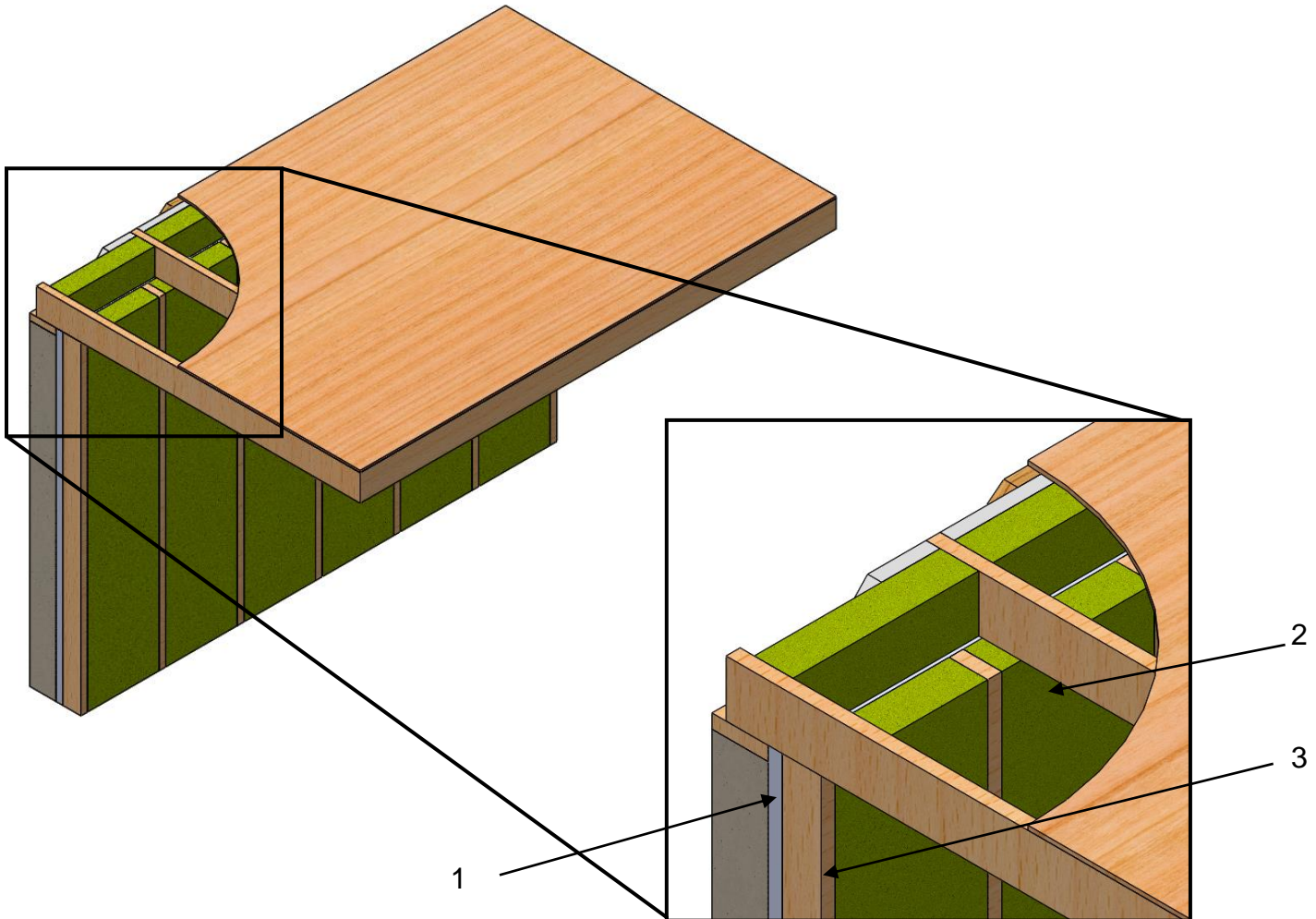

No.	COMPONENT	DESCRIPTION	
1	Foam Insulation	Type:	Foamed Plastic
		Maximum R-Value:	7.5/inch
2	Protective Covering of Foam Insulation	Certified Manufacturer:	ROCKWOOL
		Certified Product Name:	COMFORTBATT®
		Assembly Class:	<b>Classification B</b>
		Minimum Thickness:	5-1/2 inch (140 mm)
		Minimum Density:	2 lb/ft <sup>3</sup> (32 kg/m <sup>3</sup> )
		Installation:	Friction fit into wall stud cavity.
3	Wall Studs	Minimum 2 inch x 6 inch (51 mm x 102 mm) wood wall studs	

**QAI Design B1067-1e –ROCKWOOL COMFORTBOARD™ 80 / COMFORTBOARD 110 - CAN/ULC-S124 – Alternative Installation Method – Anchored Insulation Board**

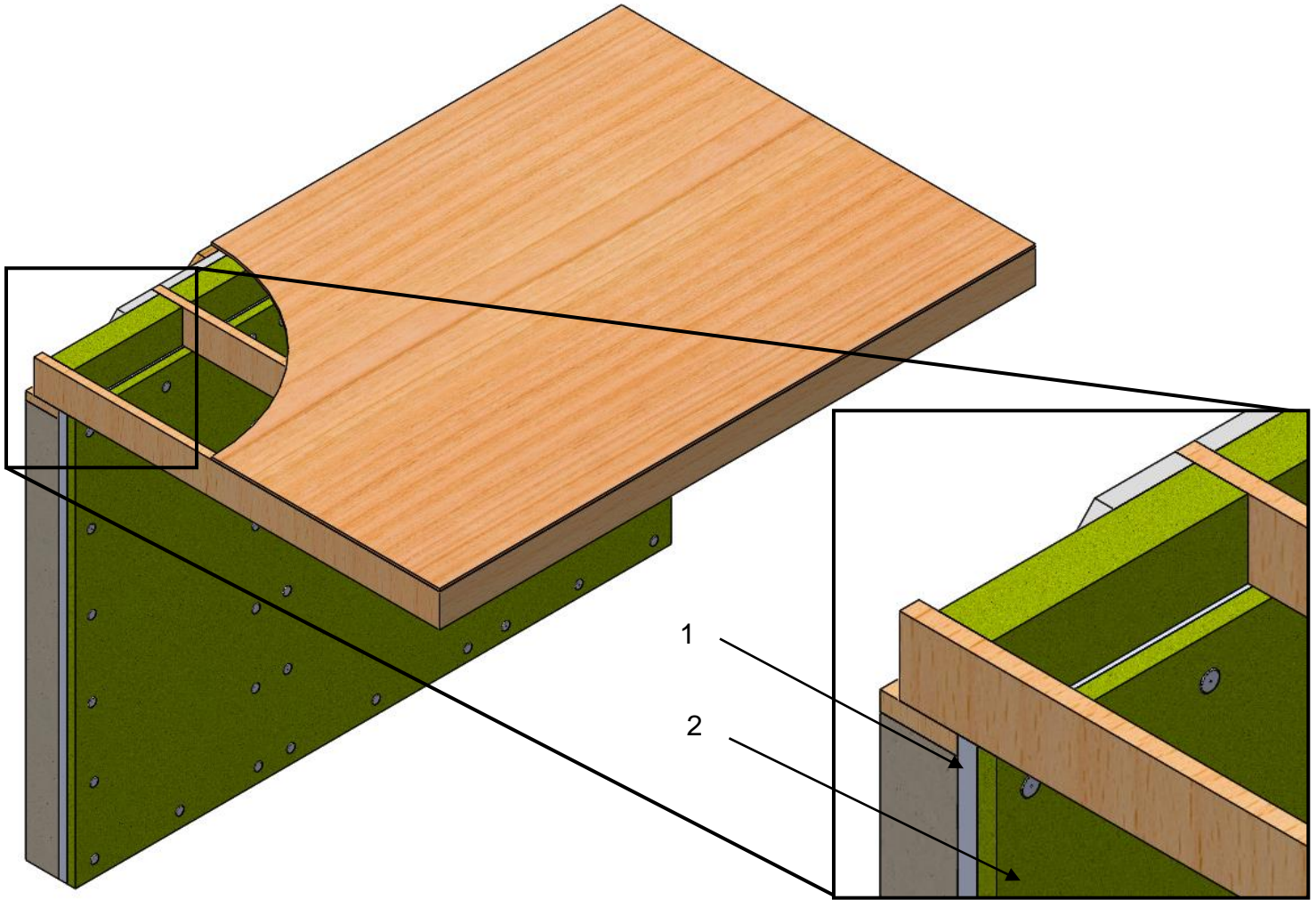

No.	COMPONENT	DESCRIPTION		
1	Foam Insulation	Type:	Foamed Plastic	
		Maximum R-Value:	7.5/inch	
2	Protective Covering of Foam Insulation	Certified Manufacturer:	ROCKWOOL	
		Certified Product Name:	ROCKWOOL COMFORTBOARD™ 80 / COMFORTBOARD™ 110	
		Assembly Class:	<b>Classification A</b>	<b>Classification B</b>
		Minimum Thickness:	3 in (76 mm)	2 in (50 mm)
		Minimum Density:	8.0 lb/ft <sup>3</sup> (128 kg/m <sup>3</sup> )	8.0 lb/ft <sup>3</sup> (128 kg/m <sup>3</sup> )
		Installation:	Fastened through the foamed plastic using Ramset Insulfast insulation fasteners or non-combustible fasteners at manufacturer's recommended instructions, anchored into code compliant substrate. Tight butt-edge fit installation.	