

**QAI Listing B1072-1B Construction Solutions DBX1000M 6 in. Dryer Vent Box  
 CAN/ULC S115, ASTM E814  
 30 Minute Membrane Penetration Assembly  
 Non-Load Bearing**

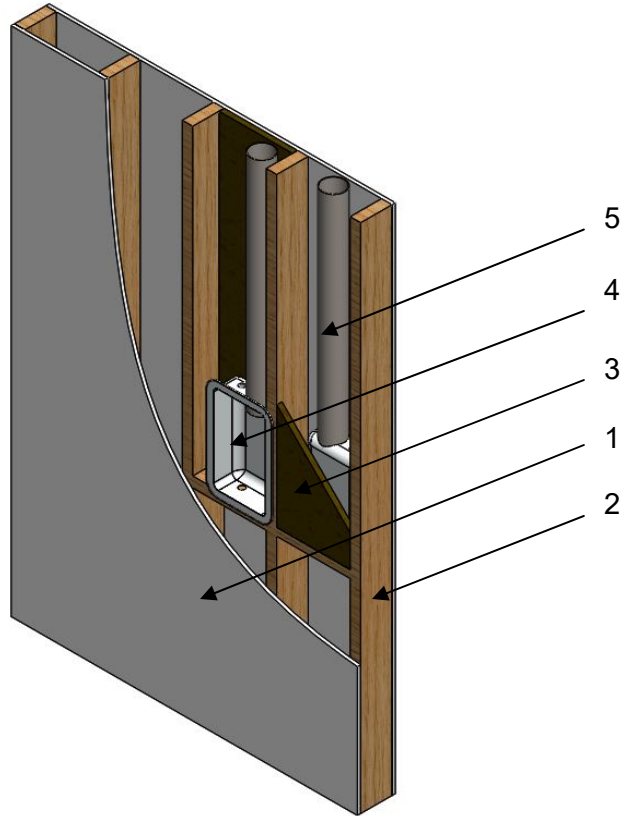

No.	COMPONENT	DESCRIPTION	
1	Gypsum Board	Type:	Type X gypsum wallboard complying with ASTM C1396 and labeled by an approved agency.
		Thickness:	Single layer of 5/8 in. (16 mm) on each face of the wall.
		Application:	Sheathing is to be fastened to studs with #6 x 1-5/8 in. (41 mm) long coarse thread drywall screws spaced at 8 in. on center. Joints to be taped and mudded, and fastener heads to be mudded.
2	Wall Studs	Stud Type:	Minimum nominal 2 x 6 in. (50 x 152 mm) wood studs.
		Stud Spaced	Maximum 16 in. (406 mm) on center.
3	Insulation	Type:	Mineral wool thermal insulation in compliance with ASTM C612 Type II, III or IVA. ASTM C612 Type II and III mineral wool insulation must also be non-combustible as defined by ASTM E136 and CAN/ULC-S114.
		Minimum Thickness:	2 inch (50 mm). See Insulation Installation below for thickness of insulation behind dryer vent box.
		Nominal Density:	Minimum 4.0 lb/ft <sup>3</sup> (64 kg/m <sup>3</sup> ).
		Installation:	A 10 in. (254 mm) x 17 in. (432 mm) area shall be cut from the 2 in. cavity insulation in the area behind the dryer vent box, a 10 in. (254 mm) x 17 in. (432 mm) piece of 1 in. insulation shall then be placed in the cut out.

No.	COMPONENT	DESCRIPTION	
4	Dryer Vent Box	Certified Manufacturer:	Construction Solutions
		Certified Product:	DBX1000M 6 in. Construction Solutions dryer vent box kit.
		Box Dimensions:	10 in. (254 mm) wide by 17 in. (432 mm) high by 5 in. (127 mm) deep with a 1-1/4 in. (32 mm) flange. A 4-3/16 in. (106 mm) circular cut out for the dryer vent on the top and 1-1/8 in. (29 mm) knockouts on the top and bottom for gas hook up. The box is formed from 22 gauge galvanized steel.
		Trim Ring Dimensions:	9-7/8 in. (251 mm) wide by 16-7/8 in. (429 mm) high by 1-5/8 in. (41 mm) deep with a 1-5/16 in. (33 mm) flange. The trim ring is made from 25 gauge galvanized steel.
		Caulking:	PFP 4800DW
	Installation:	The dryer vent box was fastened to the 2 x 6 in. (50 x 152 mm) stud and sill through three holes on each side of the box using #8 x 1-1/2 in. (38 mm) wood screws. The galvanized steel dryer vent is inserted through the top of the box then caulked at the vent/box interface. The opening cut into the gypsum board shall be a maximum of 10-1/2 in. (267 mm) wide by 17-1/2 in. (445 mm) high. Only one box is permitted per stud cavity.	
5	Vent Pipe	Size:	4 in. (101 mm) round.
		Type:	26 gauge galvanized steel.

Visit the QAI Online Listing Directory located at [www.qai.org](http://www.qai.org) for the most up to date version of this Listing and to validate that this QAI Listing is active.