

QAI LISTING B1113-1b
ECOSPAN PROFILES WALL & ROOF / CEILING PANELS
NFPA 286 ROOM CONFIGURATION

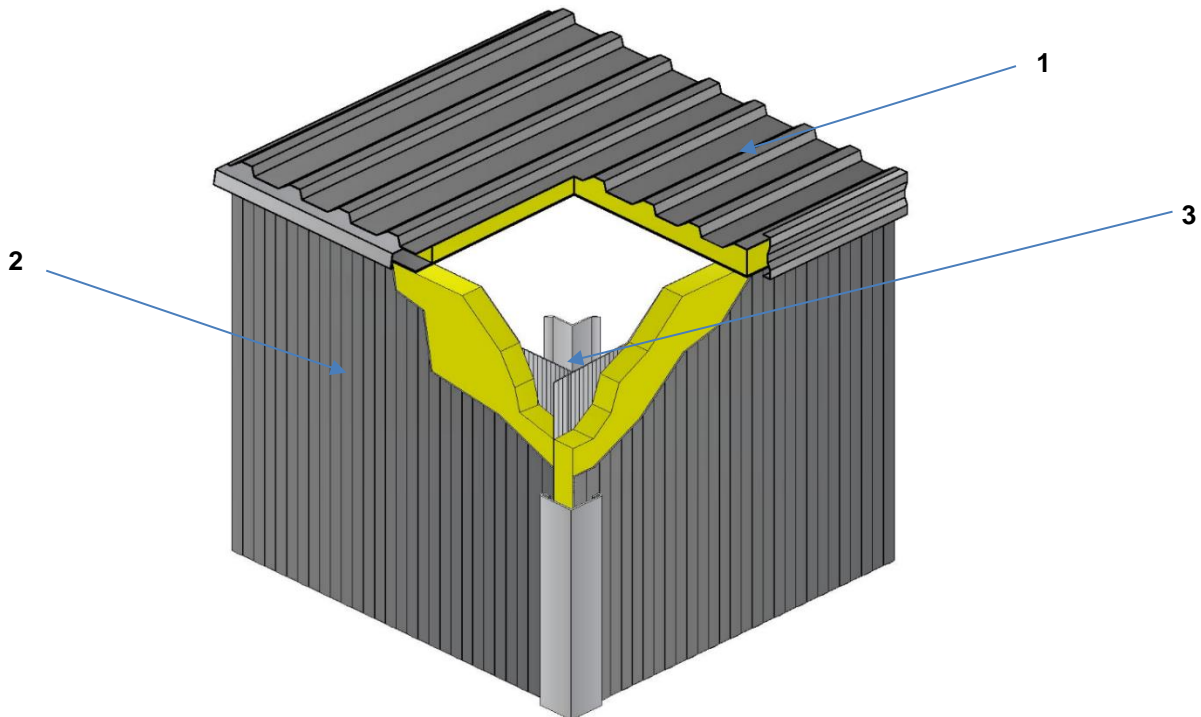

NUMBER	PART	DESCRIPTION	
1	Roof Panel	Listee:	EcoSpan Profiles Ltd.
		Approved Product(s):	Skyline Roof Panels
		Facers:	Minimum 26 Gauge (0.404 mm) steel.
		Core:	Maximum thickness 6 inches (152 mm) of maximum 2.7 lbs/ft ³ (43 kg/m ³) density polyisocyanurate foam plastic.
		Joint:	Female / Male connection. Optional fasteners and sealants can be used.
		Installation:	Friction fit joints to ensure tight connection. Joint stitching and / or joint sealant is optional.
2	Wall Panel	Listee:	EcoSpan Profiles Ltd.
		Approved Product(s):	Edge and Skyline Wall Panels
		Facers:	Minimum 26 Gauge (0.404 mm) steel.
		Core:	Maximum thickness 6 inches (152 mm) of maximum 2.7 lbs/ft ³ (43 kg/m ³) density polyisocyanurate foam plastic.
		Joint:	Female / Male connection. Optional fasteners and sealants can be used.
		Installation:	Friction fit joints to ensure tight connection. Joint stitching and / or joint sealant is optional.
3	Joint Flashing	General:	Light Gauge steel flashing mechanically secured to protect room corner joints.